

# Sto Hammer Dowel UEZ-S 8/60

(Sto-Schlagdübel UEZ-S 8/60 = EJOT ejotherrm NT U)



Insulation board anchor for External Wall Insulation Systems

Rev. INT.EN/001/09.2009

product code art.-no.	length	concrete, brickwork use categories A, B, C		aerated, lightw. concrete use categories D, E		washer diameter	packaging [pieces]
		anchorage depth	insulation thickness *)	anchorage depth	insulation thickness *)		
04878-001	95 mm	25 mm	40/50	-	-	60 mm	100
04878-002	115 mm	25 mm	60/70	-	-	60 mm	100
04878-003	135 mm	25 mm	80/90	-	-	60 mm	100
04878-004	155 mm	25 mm	100/110	-	-	60 mm	100
04878-005	175 mm	25 mm	120/130	-	-	60 mm	100
04878-006	195 mm	25 mm	140/150	-	-	60 mm	100
04878-007	215 mm	25 mm	160/170	-	-	60 mm	100
04878-015	235 mm	25 mm	180/190	-	-	60 mm	100
04878-016	255 mm	25 mm	200/210	-	-	60 mm	100
04878-017	275 mm	25 mm	220/230	-	-	60 mm	100
04878-018	295 mm	25 mm	240/250	-	-	60 mm	100

\*) Insulation thickness (renovation) = dowel length - 10 mm adhesive - 20 mm old render - anchorage depth.  
New buildings without old render layer: take the next smaller type.

## Material description

- Anchor with washer head acc. to ETAG 014 (hammer dowel), for fixing insulation boards (External Wall Insulation Systems)
- Dowel body made of polyethylene PE-HD
- Expanding nail made of galvanised steel
- Expanding nail with plastic-covered head (to minimize the punctual thermal bridge)
- Pre-assembled

Colour dowel body
natural white

## Uses

Classic	Vario	Mineral	Cell	Ceramic	Ventec	Reno
◆	◆	◆				

- For (additional) fixing of insulation boards (EPS, mineral wool etc): Sto External Wall Insulation Systems StoTherm Classic, Vario, Mineral - adhesive + dowels fixing system
- Wall construction materials:  
Concrete, solid brickwork, hollow brickwork, etc.  
(not e.g. aerated concrete)  
Use categories acc to ETA: A,B,C



## Test reports, approvals, certificates

- European Technical Approval: ETA-05/0009; DIBt – Deutsches Institut für Bautechnik in Berlin
- Technical Approval for use as a construction material in Germany: Z-21.2-1788; DIBt – Deutsches Institut für Bautechnik in Berlin

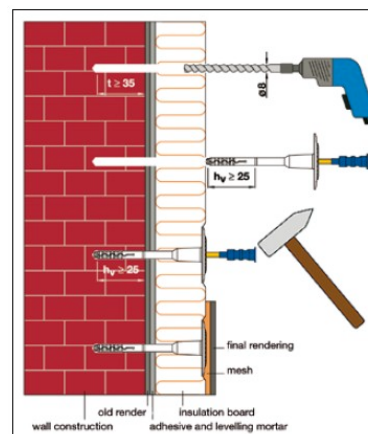

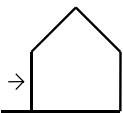

# Sto Hammer Dowel UEZ-S 8/60

(Sto-Schlagdübel UEZ-S 8/60 = EJOT ejotherm NT U)



Insulation board anchor for External Wall Insulation Systems

Rev. INT.EN/001/09.2009

## Application

- Hammerdrive dowel
- Drill hole diameter 8 mm
- Minimum anchorage depth in sustainable substrate = expansion length
- Dowel length  $\geq$  insulation thickness + adhesive thickness + non-load-bearing old render thickness + anchorage depth
- Consumption: In accordance with statical necessity and dowel tension load.  
Refer to Technical Approval of the External Wall Insulation System  
StoTherm Classic, Vario and Mineral  $\geq$  6 pcs/m<sup>2</sup>.

## Characteristic resistance to tension loads

Wall construction material	Standard	European Technical Approval	Characteristic loads (resistance to tension)
			[kN/dowel]
Concrete C 12/15	EN 206-1	ETA-05/0009	1,20
Concrete C 16/20 - C 50/60	EN 206-1		1,20
Solid clay bricks $\geq$ Mz 12	DIN 105		1,50
Sand-lime solid bricks $\geq$ KS 12	DIN 106		1,50
Lightweight-concrete solid blocks $\geq$ V 4	DIN 18 152		0,50
Vertically perforated clay bricks $\geq$ HLz 12	DIN 105-1		0,90
Sand-lime perforated bricks $\geq$ KSL 12	DIN 106		1,50
Lightweight-concrete hollow blocks $\geq$ Hbl 2	DIN 18 151		0,50
Lightweight-aggregate-concrete $\geq$ LAC 4	EN 1520		---
Autoclaved aerated concrete P2 - P7	DIN 4165		---
Vertically perforated clay bricks Hlz	ÖNORM B6124		0,75

More details: refer to ETA-05/0009, annex 4

## Special notes

Revision No. INT.EN/001

Validity: 08.09.2009

Uses not clearly described in this Technical Data Sheet should only take place after consultation with Sto AG.

The information and data serve to ensure the normal application purpose and normal application suitability.

This Technical Data Sheet is valid outside Germany, in all countries without Sto subsidiary.

## Sto AG

Ehrenbachstrasse 1

D-79780 Stühlingen

Germany

Phone: +49 7744 57-1131

Fax: +49 7744 57-2131

E-Mail: [infoservice@sto.eu.com](mailto:infoservice@sto.eu.com)

Internet: [www.sto.com](http://www.sto.com)

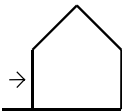

# Sto Hammer Dowel UEZ-S 8/60

(Sto-Schlagdübel UEZ-S 8/60 = EJOT ejothem NT U)



Insulation board anchor for External Wall Insulation Systems

Rev. INT.EN/001/09.2009

## Sto worldwide:

Austria Sto Ges.m.b.H. 9500 Villach	Belgium Sto nv/sa 1730 Asse	Czech Republic Sto s.r.o. 251 70 Dobřejovice	Danmark Sto Danmark A/S 2650 Hvidovre	Finland Sto Finexter Oy 01730 Vantaa	France Sto S.A.S. 95870 Bezons
Germany Sto AG 79780 Stühlingen	Hungary Sto Építőanyag Kft. 2330 Dunaharaszti	Italy Sto Italia s.r.l. 50053 Empoli (FI)	Netherlands Sto Isoned bv 4004 KD Tiel	Norway Sto Norge A/S 0664 Oslo	Poland Sto-ispo Sp. z o.o. 03-872 Warszawa
Russia ooo Sto Russia 119180 Moscow	Spain Sto Ibérica S.L. 08302 Mataró	Sweden Sto Scandinavia AB 582 77 Linköping	Switzerland Sto AG 8172 Niederglatt	United Kingdom Sto Ltd. Glasgow G52 4TG	
China Shanghai Sto Ltd. Shanghai 200001	Malaysia Sto SEA Sdn. Bhd. 81750 Masai, Johor	Singapore Sto SEA Pte Ltd Singapore 575625	USA Sto Corp. Atlanta, Georgia 30331		

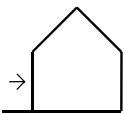

# Sto Hammer Dowel UEZ-S 8/60

(Sto-Schlagdübel UEZ-S 8/60 = EJOT ejothem NT U)



Insulation board anchor for External Wall Insulation Systems

Rev. INT.EN/001/09.2009

## Dowelling pattern

**Board size: 0,50 m<sup>2</sup>**

(EPS board 100 x 50 cm and mineral fibre board 80 x 62,5 cm)

**Dowels/m<sup>2</sup>**

